

THIS STANDARD SHOWS THE REQUIREMENTS FOR THE PV DIRECTORY PLAQUE THAT MUST BE PLACED ON THE SERVICE PANEL IN PLAN VIEW.

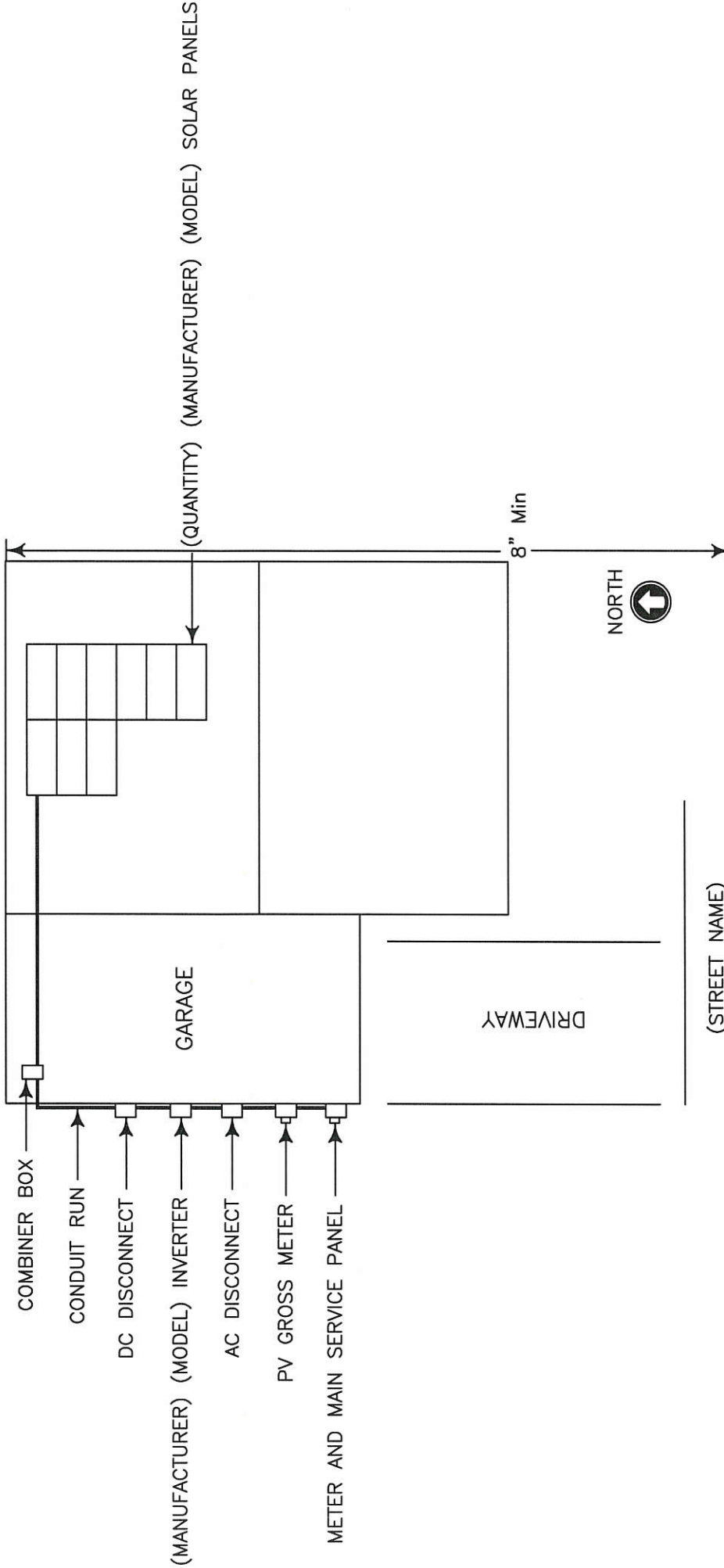

NOTES:

1. LABELS LISTED ABOVE WITH PARENTHESES INDICATE THAT THE SPECIFIC NAME MUST BE INSERTED IN PLACE OF THOSE GENERAL TERMS.
2. DIRECTORY PLACARD MUST BE PLACED ON THE CUSTOMER SIDE OF THE SERVICE PANEL IN CLEAR VIEW WITHOUT COVERING MANUFACTURER LABELING.
3. DIRECTORY PLACARD MUST BE UNIQUE TO EACH HOUSE IT REPRESENTS (I.E. ROOF LAYOUT, EQUIPMENT LOCATION, ETC.)
4. DIRECTORY PLACARD MUST BE A MINIMUM SIZE OF 6" x 8".
5. FONT STYLE SHALL BE ARIAL AND FONT SIZE SHALL NOT BE SMALLER THAN SIZE 12 AND NO LARGER THAN SIZE 28.
6. PLACARD SHALL BE RED WITH WHITE LETTERING.
7. PLACARDS SHOULD BE OF SUFFICIENT DURABILITY TO WITHSTAND THE ENVIRONMENT, PERMANENTLY ATTACHED TO SURFACE OF ELECTRICAL EQUIPMENT BY MEANS OF EPOXY OR EQUIVALENT SUITABLE FOR THE ENVIRONMENT (SCREWS OR RIVETS ARE NOT ALLOWED), AND SHALL BE EITHER METAL OR PLASTIC WITH ENGRAVED OR MACHINE PRINTED LETTERS.

REVISED: 03/22/2018

APPROVED: *Bryden Tophan 7/19/18* STANDARD DRAWINGS



PV DIRECTORY PLAQUE

**SD**

600-85